



Edwin M. Lee, Mayor
Mohammed Nuru, Director

Patrick Rivera, Division Manager

DPW Order No: 181306

ESTABLISHING PROCEDURES AND GUIDELINES FOR THE CONSTRUCTION OF REINFORCED CONCRETE IN NEW SIDEWALK.

I. PURPOSE: To establish procedures for constructing reinforced concrete sidewalks in the public right-of-way to reduce cracks and damage occurring in newly poured concrete sidewalk.

II. GENERAL INFORMATION:

- A. Cracks and damage in concrete sidewalk occur as a result of shrinkage, settlement, tree root damage, etc. When existing concrete sidewalk develops gaps, cracks, chips, displacement, holes, or other defects, permanent repairs or replacement of the sidewalk shall be required in order to maintain defect-free sidewalk and provide a safe public environment.
- B. DPW follows the standards established in the 2010 ADA Standards and California Title 24, which identifies a ¼ inch or greater displacement or gap as a defect subject to repair to comply with accessibility guidelines and regulations. The typical process to repair a sidewalk defect is the removal and replacement of the sidewalk as specified in the City's Standard Specifications (Section 204).
- C. DPW will continue to monitor the condition of the City's sidewalks and require defects to be repaired either by the City for City-owned sidewalks or by the fronting property owners. Public Works Code Section 706 makes it the duty and responsibility of the property owners to maintain sidewalk in front of and adjacent to their properties in good repair and condition.
- D. Reducing cracking will improve safety for all pedestrians, including those in wheelchairs, and those who use walkers, canes, and scooters; and parents with strollers.

III. GUIDELINES:



- A. New reinforced concrete sidewalk shall be constructed in accordance with the SFDPW Standard Plan 96,608 and the SFDPW Standard Specification Section 204 with #3 steel reinforced bars at mid-depth of the concrete sidewalk slab.
- B. The requirement for reinforcement in new concrete sidewalk shall be effective upon the adoption of this DPW Order. Reinforcement shall be required for new sidewalk on a diagonal to all re-entrant corners (property corners, curb ramps, pull boxes, etc.).
- C. Permits issued after the adoption of this DPW Order shall be constructed per the new DPW Steel Reinforced Bars for Sidewalk Construction Standard Plan, File No. 96,608.
- D. City construction contracts advertised after the adoption of this DPW Order shall be constructed per the new DPW Steel Reinforced Bars for Sidewalk Construction Standard Plan, File No. 96,608.
- E. A minimum 2 inch distance is required from the edges of the reinforcement to a construction joint for adequate protection.
- F. Steel reinforcement bars shall have a minimum 3 foot bar length with a 3 inch on center spacing. At locations where the bar length is restricted, a 2 foot bar length is acceptable with the approval of the Engineer.

9/25/2013

9/26/2013

X *Patrick Rivera*

X *Fuad Swais*

Rivera, Patrick
Division Manager, IDC

Swais, Fuad
Deputy Director for Infrastructure and City En...

9/26/2013

X Mohammed Nuru

Nuru, Mohammed
Director, DPW



NOTES:

1. ALL CURB RAMP SHALL BE POURED SEPARATELY FROM SIDEWALK AND SHALL CONTRAST VISUALLY WITH ADJACENT SIDEWALK SURFACES. IN ACCORDANCE WITH CITY STANDARD SIDEWALKS AS DEFINED IN SECTION 204 OF DPW STANDARD SPECIFICATIONS AND CURB RAMP STANDARD PLANS FILE NO 55.017 TO 55.018.
2. CURB RAMP AND SIDEWALK SLAB--ON--GRADE ACCORDING TO SFDW STANDARD SPECIFICATION SECTION 204 WITH #3 STEEL REINFORCED BARS AT MID-DEPTH OF THE CONCRETE SIDEWALK SLAB
3. MINIMUM 3-FOOT REINFORCED BAR LENGTH WITH 3-INCH O.C. SPACINGS AT LOCATIONS WHERE 3-FOOT REINFORCEMENT BAR LENGTH IS RESTRICTED, 2-FOOT REINFORCEMENT BAR LENGTH IS ACCEPTABLE WITH THE APPROVAL OF THE ENGINEER.
4. A 2-INCH MINIMUM DISTANCE IS REQUIRED FROM THE EDGES OF THE REINFORCEMENT TO A CONSTRUCTION JOINT.
5. INSTALL REINFORCEMENT ON A DIAGONAL TO ALL RE-ENTRANT CORNERS (PROPERTY CORNERS, CURB RAMP, PULL BOXES, ETC).
6. SCORE JOINTS SHALL HAVE A 1/4-INCH DEPTH AND BE IN ACCORDANCE WITH CITY STANDARD SIDEWALKS AS DEFINED IN SECTION 204 OF DPW STANDARD SPECIFICATIONS.
7. CONTRACTION JOINTS SHALL BE SPACED A MAXIMUM OF 15 FEET APART AND SHALL ENCLOSE AN AREA NO MORE THAN 250 SQUARE FEET.
8. FOR SAW CUT CONTRACTION JOINTS, CUT SLAB IMMEDIATELY AFTER INITIAL CONCRETE SET AND BEFORE FINAL CURING.

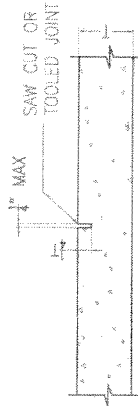

CONTRACTION JOINT

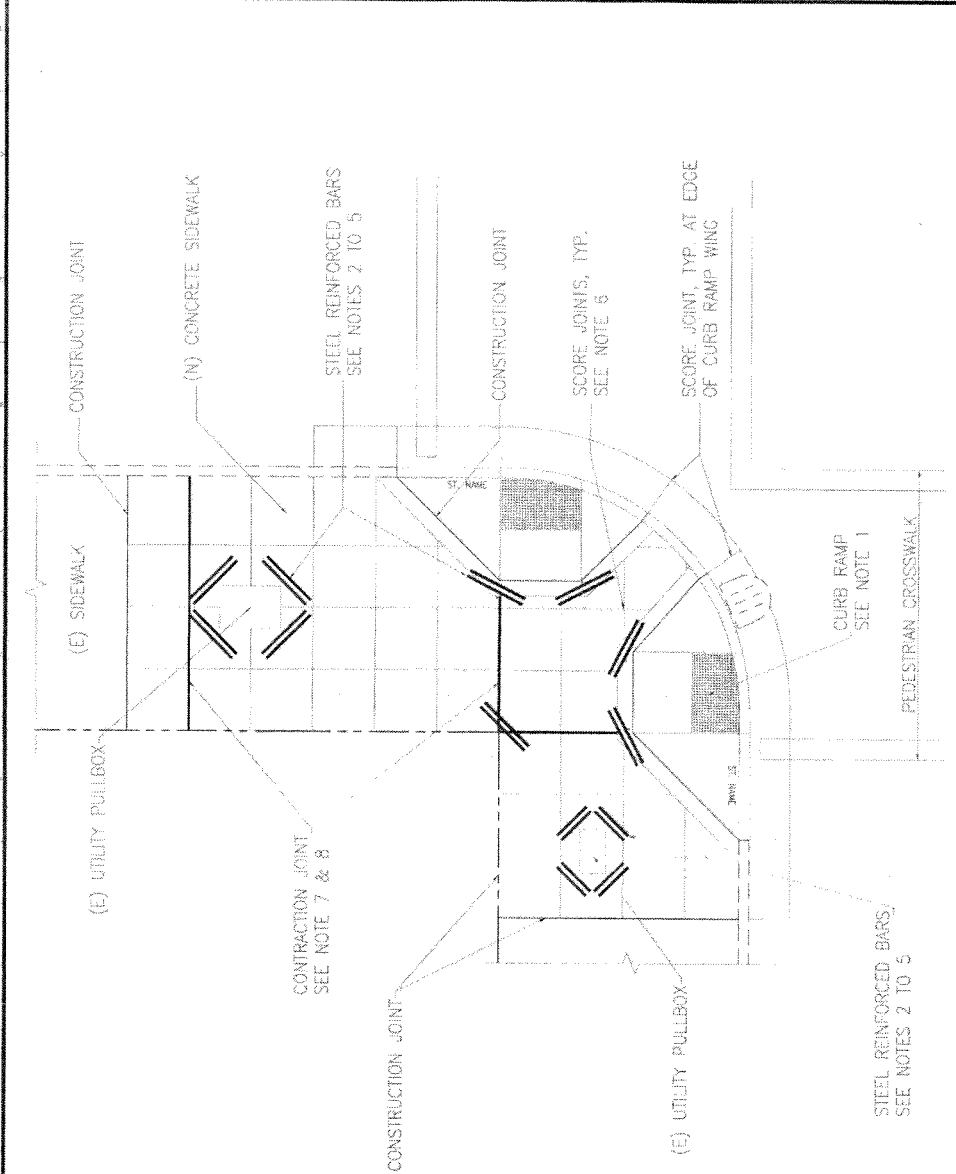

**REINFORCED SIDEWALK PLAN
TYPICAL LAYOUT
(NOT TO SCALE)**

This Standard Plan was developed for use on public works projects in the City and County of San Francisco, and shall not be used without consulting a Registered Professional Engineer. The Department of Public Works reserves the right to make revisions to this Standard Plan at any time.

STANDARD PLAN	DRAWING NO.	NONE
STREETS AND HIGHWAYS	FILE NO.	96.608
STEEL REINFORCED BARS FOR SIDEWALK CONSTRUCTION	DRAWING NO.	

DATE	BY	CHK	APP
09/20/13	JK	JK	JK
DATE	BY	CHK	APP
09/20/13	JK	JK	JK
DATE	BY	CHK	APP
09/20/13	JK	JK	JK

INFRASTRUCTURE DIVISION
DEPARTMENT OF PUBLIC WORKS
CITY AND COUNTY OF SAN FRANCISCO



DATE	DESCRIPTION	BY	APP

REVISION INFORMATION & FILE NO. OF DRAWING

Drawing No. 96.608, City and County of San Francisco, Department of Public Works, Infrastructure Division, Standard Plan for Streets and Highways, Steel Reinforced Bars for Sidewalk Construction.